

**Application for a New Premises Licence**

**SAINSY'S PIE SHOP, 111 HIGH STREET, BRENTWOOD CM14 4RX**

# **APPENDIX B**

*Current Premises Licence*

*issued 12 November 2021*

*OS Maps & Images*





## Premises Licence

<b>Premises Licence Number</b>	PRM_0587
<b>Application Number</b>	21/00017/LAPRE
<b>Date of Issue</b>	12 November 2021

### Part 1 – Premises Details

Postal address of premises, or if none, ordnance survey map reference or description, including Post Town, Post Code
<b>Sainsy's Pie Shop 111 High Street Brentwood Essex CM14 4RX</b>
Telephone number
<b>01277 295943</b>

Where the licence is time limited the dates
---

Licensable activities authorised by the licence
<b>Provision of Late-Night Refreshments Sale by Retail of Alcohol</b>

Times the licence authorises the carrying out of licensable activities
<b>Provision of Late-Night Refreshments</b>
<b>Saturday</b> 23:00 - 00:00
<b>Sale by Retail of Alcohol</b>
<b>Monday-Friday</b> 10:00 - 23:00
<b>Saturday</b> 10:00 - 00:00
<b>Sunday</b> 11:00 - 22:00

The opening hours of the premises
<b>Monday-Friday</b> 10:00 - 23:30
<b>Saturday</b> 10:00 - 00:30
<b>Sunday</b> 11:00 - 22:30

Where the licence authorises supplies of alcohol whether these are on and / or off supplies
<b>Alcohol is supplied for consumption both on and off the Premise</b>

## Part 2

Name, (registered) address, telephone number and email (where relevant) of holder of premises licence

**D Sainsy's Pie Shop Ltd.**  
**95 Western Road**  
**Billericay**  
**CM12 9DT**

Registered number of holder, for example company number, charity number (where applicable)

**Company Number**                      **12736216**

Name, address and telephone number of designated premises supervisor where the premises licence authorises for the supply of alcohol

**Daniel Barrie Sains**

Personal licence number and issuing authority of personal licence held by designated premises supervisor where the premises licence authorises for the supply of alcohol

**Personal Licence Number: BAS/PM 6332**  
**Licensing Authority: Basildon Borough Council**

## **Annex 1 – Mandatory conditions**

- 1 No supply of alcohol may be made under this licence**
    - a) At a time when there is no designated supervisor in respect of it or,**
    - b) At a time when the designated premises supervisor does not hold a personal licence or his personal licence is suspended**
  
  - 2 Every supply of alcohol made under this licence must be made or authorised by a person who holds a personal licence.**
  
  - 3 (1) The responsible person must ensure that staff on relevant premises do not carry out, arrange or participate in any irresponsible promotions in relation to the premises.**  
  
**(2) In this paragraph, an irresponsible promotion means any one or more of the following activities, or substantially similar activities, carried on for the purpose of encouraging the sale or supply of alcohol for consumption on the premises—**
    - (a) games or other activities which require or encourage, or are designed to require or encourage, individuals to— .**
      - (i) drink a quantity of alcohol within a time limit (other than to drink alcohol sold or supplied on the premises before the cessation of the period in which the responsible person is authorised to sell or supply alcohol), or .**
      - (ii) drink as much alcohol as possible (whether within a time limit or otherwise);**
    - (b) provision of unlimited or unspecified quantities of alcohol free or for a fixed or discounted fee to the public or to a group defined by a particular characteristic in a manner which carries a significant risk of undermining a licensing objective; .**
    - (c) provision of free or discounted alcohol or any other thing as a prize to encourage or reward the purchase and consumption of alcohol over a period of 24 hours or less in a manner which carries a significant risk of undermining a licensing objective; .**
    - (d) selling or supplying alcohol in association with promotional posters or flyers on, or in the vicinity of, the premises which can reasonably be considered to condone, encourage or glamorise anti-social behaviour or to refer to the effects of drunkenness in any favourable manner; .**
    - (e) dispensing alcohol directly by one person into the mouth of another (other than where that other person is unable to drink without assistance by reason of disability).**
- 
- 4 The responsible person must ensure that free potable water is provided on request to customers where it is reasonably available.**

5 (1) The premises licence holder or club premises certificate holder must ensure that an age verification policy is adopted in respect of the premises in relation to the sale or supply of alcohol.

(2) The designated premises supervisor in relation to the premises licence must ensure that the supply of alcohol at the premises is carried on in accordance with the age verification policy.

(3) The policy must require individuals who appear to the responsible person to be under 18 years of age (or such older age as may be specified in the policy) to produce on request, before being served alcohol, identification bearing their photograph, date of birth and either—

- (a) a holographic mark, or
- (b) an ultraviolet feature

6 The responsible person must ensure that—

(a) where any of the following alcoholic drinks is sold or supplied for consumption on the premises (other than alcoholic drinks sold or supplied having been made up in advance ready for sale or supply in a securely closed container) it is available to customers in the following measures—

- (i) beer or cider: ½ pint;
- (ii) gin, rum, vodka or whisky: 25 ml or 35 ml; and,
- (iii) still wine in a glass: 125 ml;

(b) these measures are displayed in a menu, price list or other printed material which is available to customers on the premises; and .

(c) where a customer does not in relation to a sale of alcohol specify the quantity of alcohol to be sold, the customer is made aware that these measures are available."

7 (A). A relevant person shall ensure that no alcohol is sold or supplied for consumption on or off the premises for a price which is less than the permitted price.

(B).For the purposes of the condition set out in paragraph 1 -

(a) "duty" is to be construed in accordance with the Alcoholic Liquor Duties Act 1979;

(b) "permitted price" is the price found by applying the formula where-

$$P = D + (D \times V)$$

- (i) P is the permitted price,
- (ii) D is the amount of duty chargeable in relation to the alcohol as if the duty were charged on the date of the sale or supply of the alcohol, and
- (iii) V is the rate of value added tax chargeable in relation to the alcohol as if the value added tax were charged on the date of the sale or supply of the alcohol;

(c) "relevant person" means, in relation to premises in respect of which there is in force a premises licence-

(i) the holder of the premises licence,

(ii) the designated premises supervisor (if any) in respect of such a licence, or

(iii) the personal licence holder who makes or authorises a supply of alcohol under such a licence;

(d) "relevant person" means, in relation to premises in respect of which there is in force a club premises certificate, any member or officer of the club present on the premises in a capacity which enables the member or officer to prevent the supply in question; and

(e) "valued added tax" means value added tax charged in accordance with the Value Added Tax Act 1994.

3. Where the permitted price given by Paragraph (b) of paragraph 2 would (apart from this paragraph) not be a whole number of pennies, the price given by that sub-paragraph shall be taken to be the price actually given by that sub-paragraph rounded up to the nearest penny.

4.—(1) Sub-paragraph (2) applies where the permitted price given by Paragraph (b) of paragraph 2 on a day ("the first day") would be different from the permitted price on the next day ("the second day") as a result of a change to the rate of duty or value added tax.

(2) The permitted price which would apply on the first day applies to sales or supplies of alcohol which take place before the expiry of the period of 14 days beginning on the second day.

8 Only individuals licensed by the Security Industry Authority may be used at the premises to guard against:

a) Unauthorised access or occupation (e.g. through door supervision), or

b) Outbreaks of disorder, or

c) Damage

## **Annex 2 – Conditions consistent with the Operating Schedule**

- 1 The premises shall install a CCTV system which will:**
  - (a) Operate at all times that the premises are open to the public**
  - (b) Capture images digitally and will have date and time stamps on them**
  - (c) Images to be retained for a period of at least 30 days**
  - (d) Cameras must be of sufficient sensitivity to enable them to operate as required under their normal working conditions and lighting levels**
  - (e) External cameras should be capable of giving useable images under a variety of weather and lighting conditions**
  - (f) Copies of CCTV footage to be provided to the police or licensing authority on reasonable request**
- 2 Signs must be displayed at all entrances (and exits) advising customers that CCTV is operating at the premises & shall be a minimum size of 200 x 148 mm & clearly legible at all times when the premises conducts licensable activities.**
- 3 The premises will install and maintain a security alarm.**
- 4 On occasions when licensable activity takes place on the premises beyond 10pm on any day, the management will risk assess the requirement for SIA doorstaff to be employed at the premises. Evidence of this risk assessment to be made available for inspection by police or licensing authority on reasonable request.**
- 5 All SIA licensed door supervisors engaged at the premises for the purpose of supervising or controlling queues or customers must wear a form of high visibility clothing (jackets/vests/armbands).**
- 6 Clear and legible notices must be prominently displayed at all exits requesting customers to respect local residents and leave the area quietly. These signs shall be a minimum size of 200mm x 148 mm.**
- 7 Where home deliveries of alcohol are made the following conditions shall apply:**
  - (a) Deliveries of alcohol shall only be made to residential dwellings or a place of work with a recognisable postcode**
  - (b) The premises licence holder shall maintain a record of all delivery companies used and such record shall be made available for inspection by the Police or an authorized officer of the council**
  - (c) Where Internet /telephone sales are placed, age verification must be obtained before the sale takes place.**
  - (d) Acceptable forms of ID must be checked on point of delivery and notice of this will be advertised on the company website.**



- 8 An incident log shall be kept at the premises, and made available on request to an authorised officer of the council or the police, which will record the following;
  - a. All crimes reported:
  - b. All ejections of patrons.
  - c. Any complaints received.
  - d. Any incidents of disorder.
  - e. Seizure of drugs or offensive weapons.
  - f. Any faults in the CCTV system.
  - g. Any refusal of the sale of alcohol.
  - h. Any visit by a relevant authority or emergency service.
- 9 The premises will be predominantly laid out to tables and chairs.
- 10 Substantial food will be available at all times the premises is conducting licensable activity.
- 11 A Challenge 25 scheme shall be operated, whereby any person who appears to be under the age of 25 years of age is required to produce on request an item which meets the mandatory age verification requirement (photo, name, date of birth & either a holographic mark or ultraviolet feature) and is either a:
  - (a) Proof of age card bearing the PASS Hologram;
  - (b) Photocard driving licence;
  - (c) Passport; or
  - (d) Ministry of Defence Identity Card.
- 12 Suitable and sufficient signage advertising the "Challenge 25" policy will be displayed in prominent locations in the premises.
- 13 An appropriate number of first aid kits shall be maintained and available at all times.
- 14 No noise from deliveries that may take place to residential properties will give rise to public nuisance.
- 15 Staff shall receive training in relation to the sale of alcohol commensurate with their duties.

Staff training will be refreshed every 6 months.
- 16 A record of staff training shall be kept on the premises and made available to a designated member of the responsible authorities on request.

**Annex 3 – Conditions attached after a hearing by the licensing authority**

## Annex 4 – Plans

This licence is issued subject to the following attached plan dated 20 July 2021 and marked **111 HIGH STREET, BRENTWOOD, ESSEX CM14 4RX**

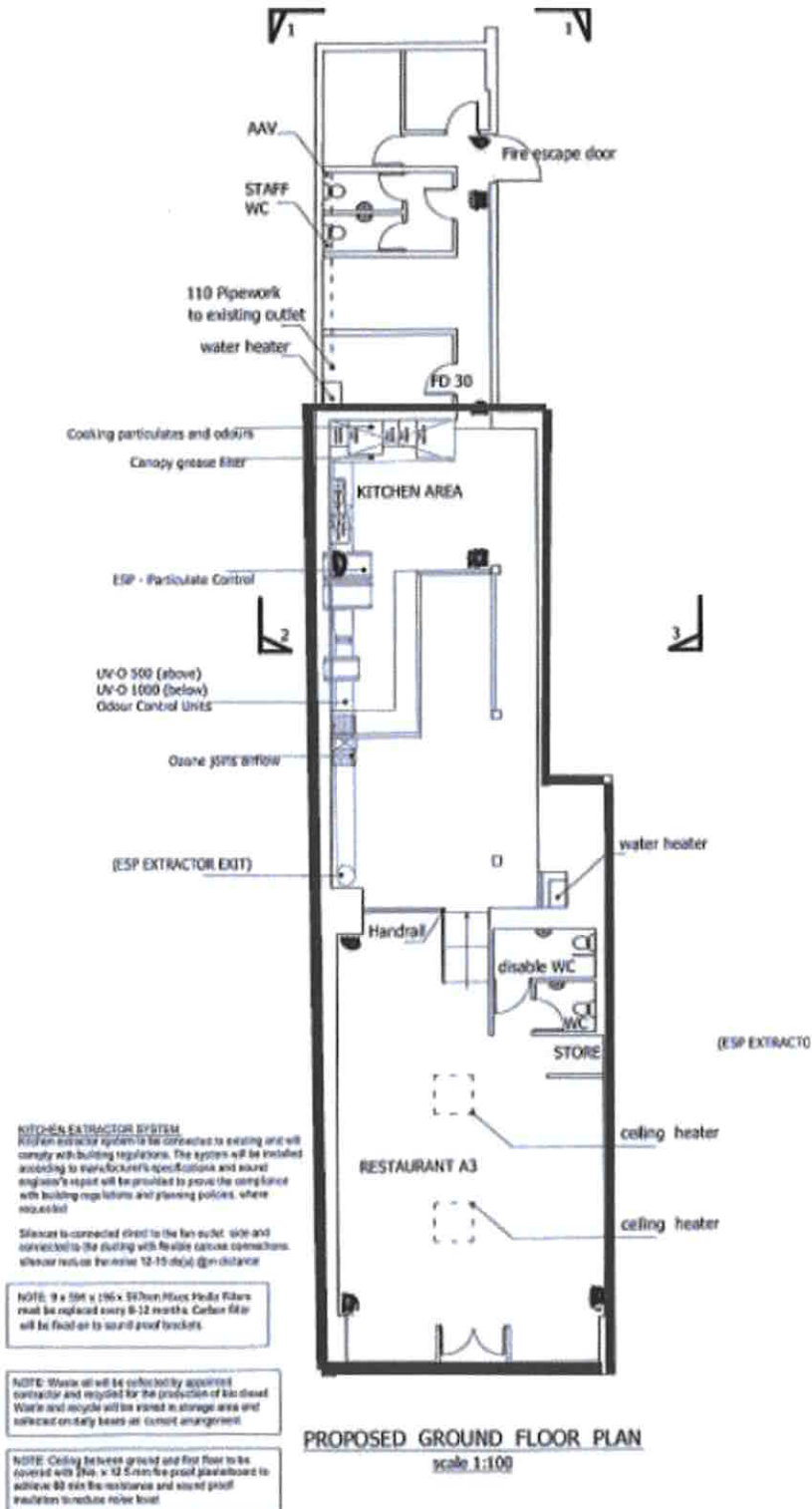





The opening hours of the premises

<b>Monday-Friday</b>	<b>10:00 - 23:30</b>
<b>Saturday</b>	<b>10:00 - 00:30</b>
<b>Sunday</b>	<b>11:00 - 22:30</b>

Where the licence authorises supplies of alcohol whether these are on and / or off supplies

**Alcohol is supplied for consumption both on and off the Premise**

Name, (registered) address of holder of premises licence

**D Sainsy's Pie Shop Ltd.  
95 Western Road  
Billericay  
CM12 9DT**

Registered number of holder, for example company number, charity number (where applicable)

**Company Number                      12736216**

Name of designated premises supervisor where the premises licence authorises for the supply of alcohol

**Daniel Barrie Sains**

Personal licence number and issuing authority of personal licence held by designated premises supervisor where the premises licence authorises for the supply of alcohol

**Personal Licence Number: BAS/PM 6332  
Licensing Authority: Basildon Borough Council**

State whether access to the premises by children is restricted or prohibited











# Legend

 SAINSY'S PIE & MASH SHOP, 111 HIGH STREET, BRENTWOOD CM14 4RX

# BRENTWOOD



## SAINSY'S PIE & MASH SHOP, 111 HIGH STREET, BRENTWOOD CM14 4RX

Drawing No. :  
Scale at A4 : 1:1250  
Drawn by : OSJ  
Service : ICT  
Date : 28th July 2022



Jonathan Stephenson  
Chief Executive  
Brentwood Borough Council  
Town Hall, Ingrave Road  
Brentwood, CM15 8AY  
Tel.: (01277) 312500



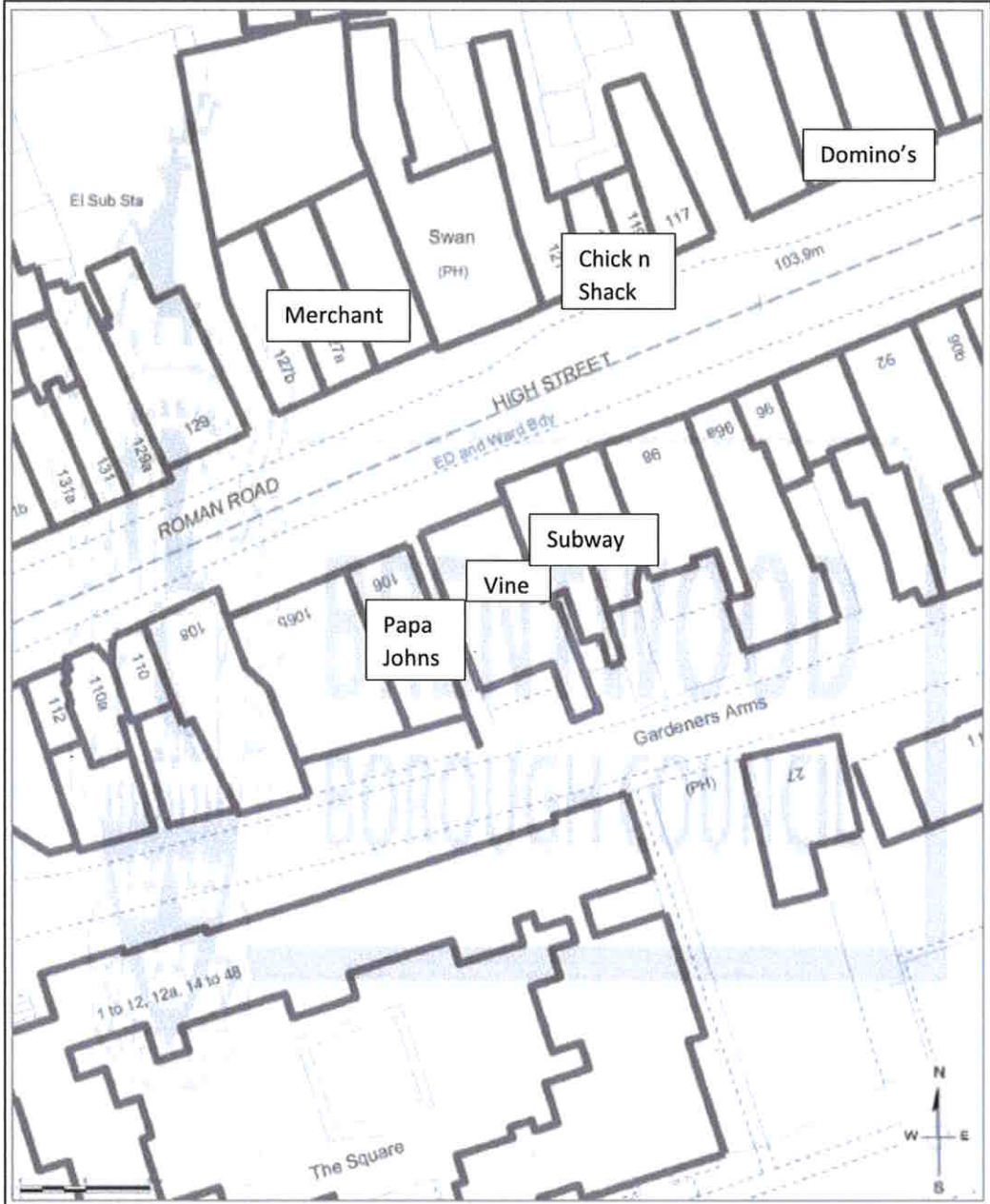

<input type="text"/> High Street, Brentwood		 <b>BRENTWOOD</b> BOROUGH COUNCIL
Drawing No. : Scale at A4 : 1:500 Drawn by : OSJ Service : ICT Date : <input type="text"/>	<input type="text"/> Chief Executive Brentwood Borough Council Town Hall, Ingrave Road Brentwood, CM15 8AY Tel.: (01277) 312500	
<small>© Crown copyright and database rights 2017 Ordnance Survey 100016309</small>		

